



- Patented handle design makes every job faster and easier
- Durable GorillaGrip® handle is stronger than steel handles
- Precision cut and chamfered tip ensures full tool engagement in the screw

Color-Coded

- Inch
- Metric
- TORX®
- Inch/Metric
- Motorcycle
- Utility



High Torque Steel:

Up to 20% stronger, with more torque and twice the wear resistance of standard grades of steel.

FINISH OPTIONS:



Corrosion-resistant finish:

Environmentally safe, provides better tool grip, resists solvents and is 5 times more corrosion resistant than competitor finishes.



Next generation chrome finish:

Traditional plated tool look with superior protection and durability.



Real 14 karat gold finish:

Superior protection and durability over traditional chrome and the look and shine of real gold.

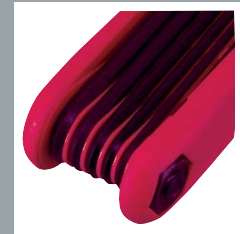

Patented Flutes allow for easy selection of one tool at a time.



Blades are accessed from both the top and bottom, eliminating the constant 'unstacking' of blades.

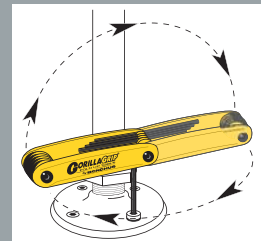

Turn & Flip Feature eliminates constant removal and repositioning in screw head when working against obstructions.

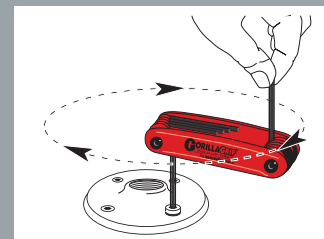

90° stop converts the tool into a non-stop, time saving, speed wrench.