

Glass Setting Procedure:

Apply pre-shimmed glazing tape on fixed leg of glazing frame. Set (2) setting blocks at 1/4 points at sill of frame. Set the glass lite against the glazing tape. Install the glass stops (#40001). Cut the wedge gasket to proper length: D.L.O. + 1%. Tuck both ends of the gasket into the frame, then tuck the middle and continue to tuck the center location of remaining length until gasket is fully installed. Continue this method of installing the gasket on the remaining sides of the frame until the installation is complete.

GLASS SIZE FORMULA:
 $DLO + 1" (H \& W)$

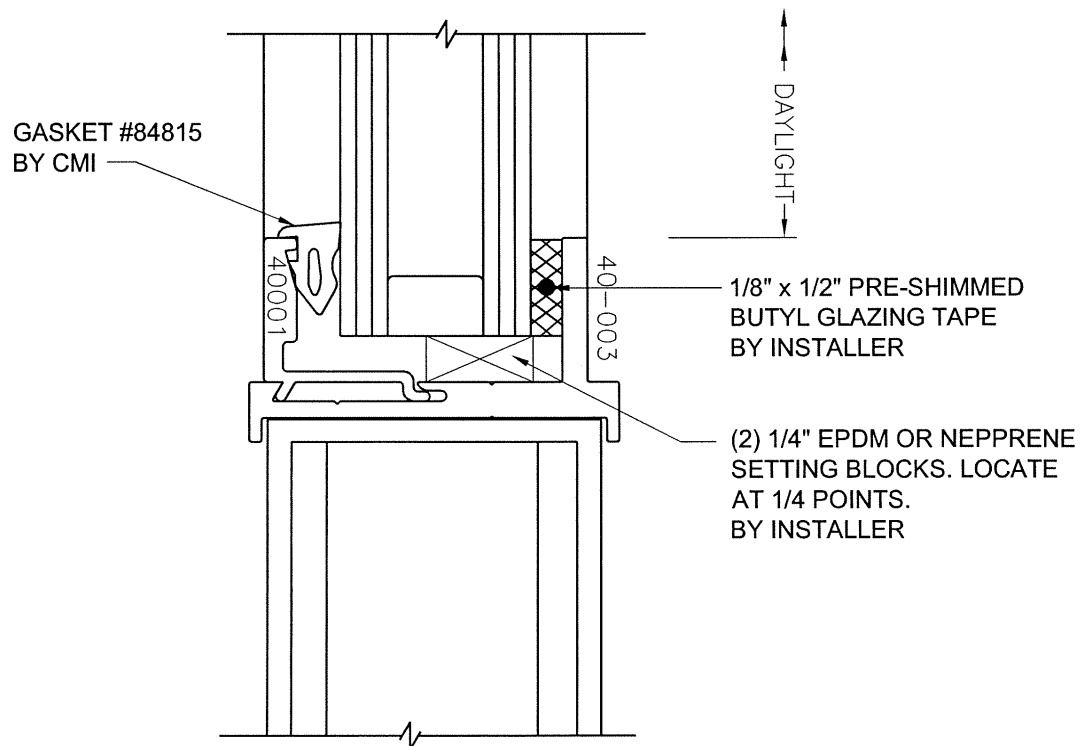

1" GLASS LITE

SERIES 4000 DOORS

CMI Architectural

Glass Setting Procedure:

Apply pre-shimmed glazing tape on fixed leg of glazing frame. Set (2) setting blocks at 1/4 points at sill of frame. Set the glass lite against the glazing tape. Install the glass stops (#40001). Cut the wedge gasket to proper length: D.L.O. + 1%. Tuck both ends of the gasket into the frame, then tuck the middle and continue to tuck the center location of remaining length until gasket is fully installed. Continue this method of installing the gasket on the remaining sides of the frame until the installation is complete.

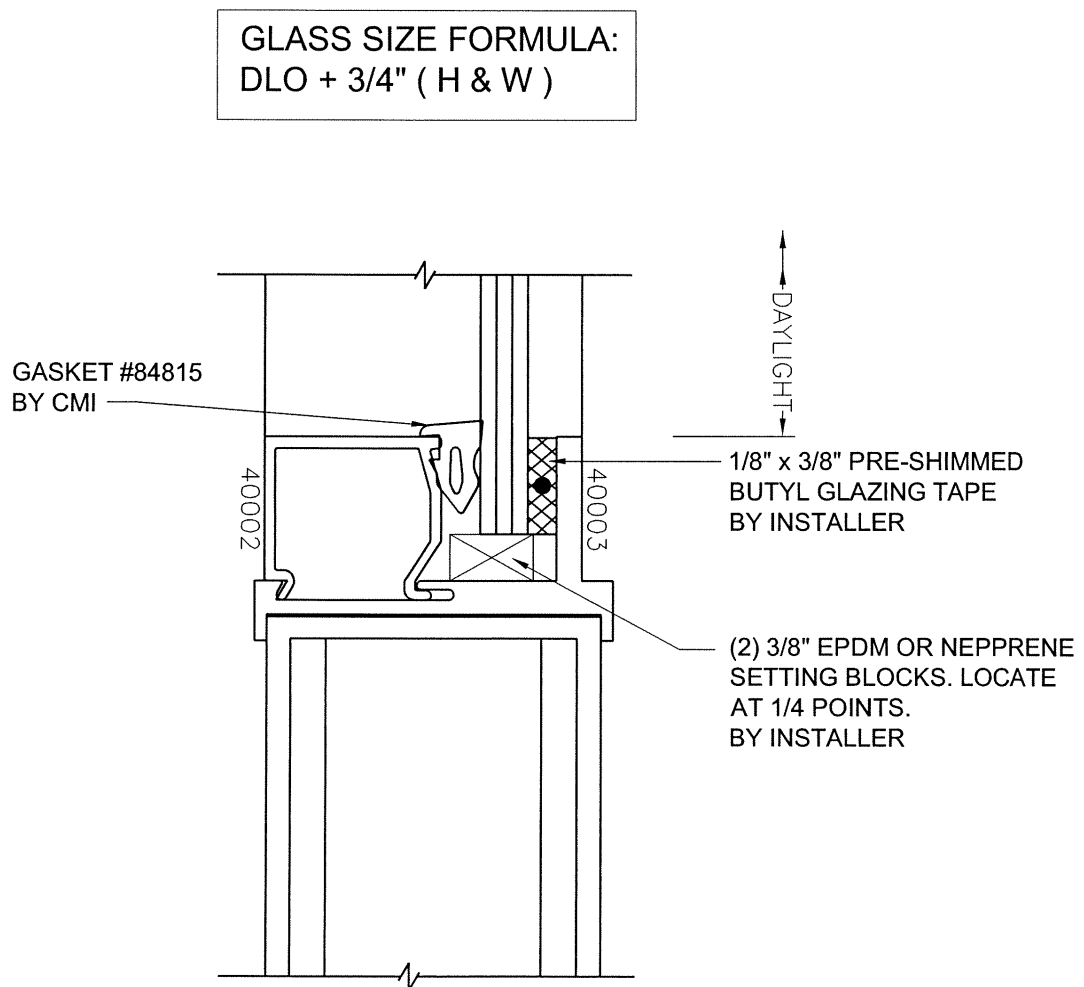

1/4" GLASS LITE

SERIES 4000 DOORS

Glass Setting Procedure:

Pre-set two narrow setting blocks at 1/4 points on exterior side of frame. Using glass cups; hold glass at exterior side of frame in panel opening. Pre-set two more narrow setting blocks on interior frame sill at 1/4 points. Bring interior side of frame into assembly position, allow glass to slide down onto the setting blocks, then install assembly screws with evenly applied pressure.

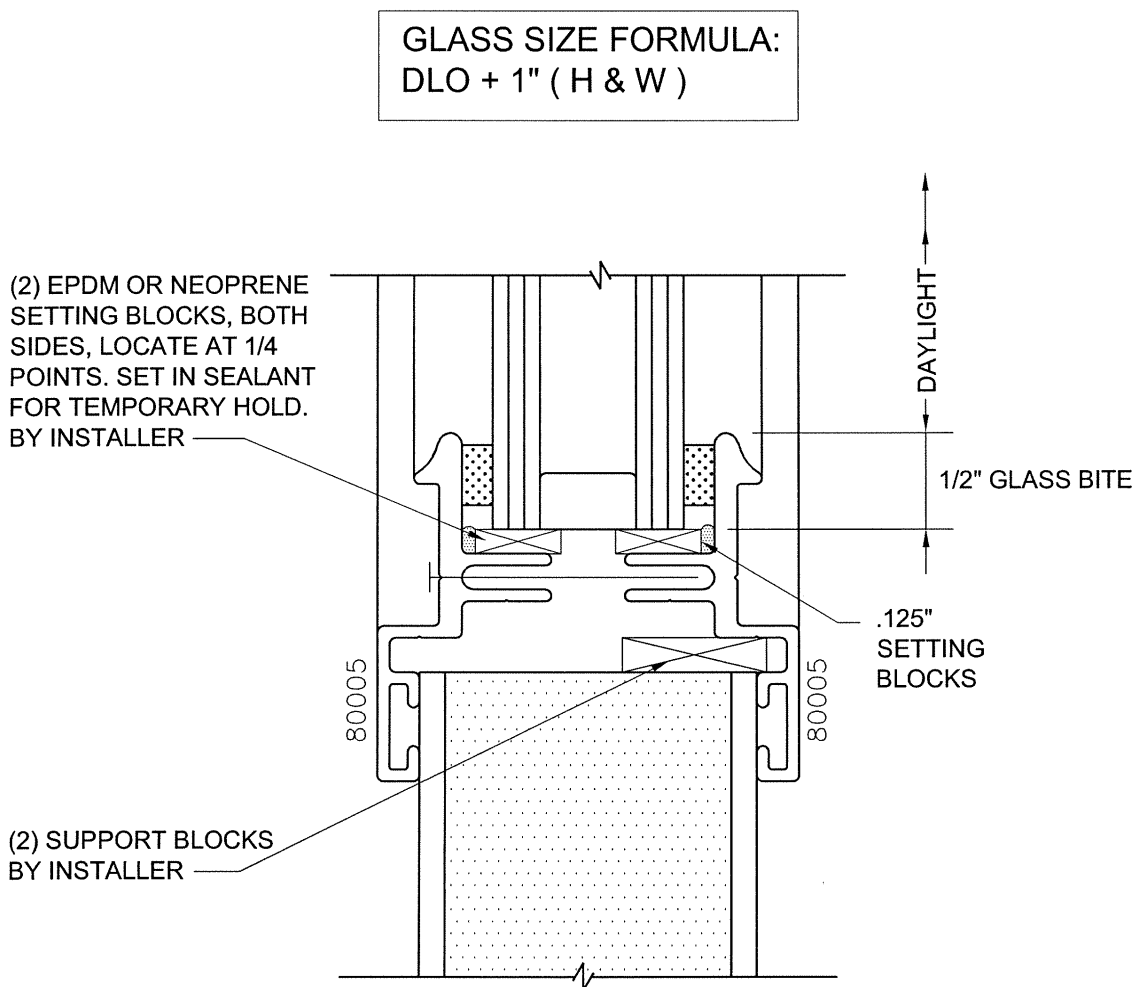

1" GLASS LITE

SERIES 8000 / 9000 DOORS

CMH Architectural

Glass Setting Procedure:

Pre-set two setting blocks on exterior side of frame. Using glass cups; support weight of glass & hold against exterior side of frame. Bring interior side of frame into position being careful to properly engage setting blocks for full support. Allow glass to bear weight on the setting blocks, then tighten frame assembly screws with evenly applied pressure.

GLASS SIZE FORMULA:
 $DLO + 3/4" (H \& W)$

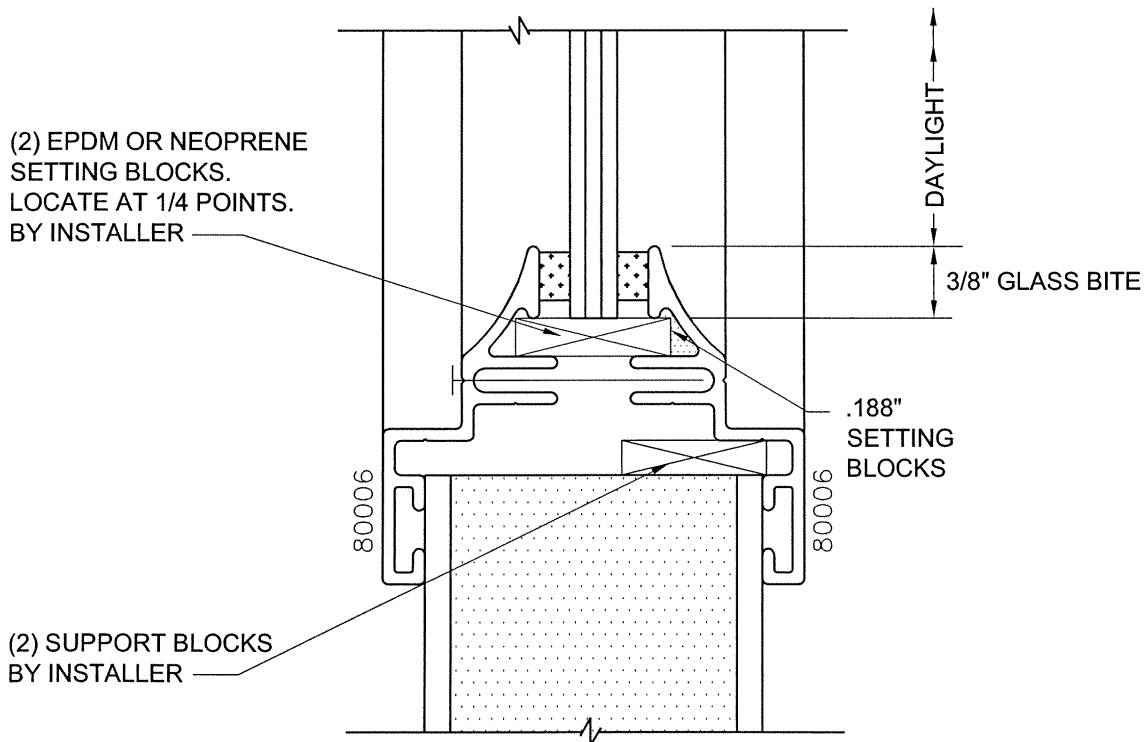

1/4" GLASS LITE

SERIES 8000 / 9000 DOORS

CMH Architectural