

Minnesota Chemical Company Service, Parts and Equipment Warehouse

How We Support You:



Ed Jensen, Service Manager, takes your calls, dispatches service staff to your facility and helps fix many washer/dryer problems over the phone.



Barb Swanson, Parts Manager, takes your calls, makes sure you have the correct parts, ships from our stock or places the order with the factory.



Bruce Edwards receives equipment, stores equipment in the warehouse for shipment, will call by customers or delivery by our service staff.



We stock many Huebsch dryers, home style and washers and many Milnor washers.

How can we serve you for your equipment repair or parts needs?



FREE FALL SHOWS

Coin Laundry and On Premise Laundry for hotels, nursing homes, schools and hospitals

Meet industry experts. Learn how to take care of your washers and dryers. Inside tips on preventative maintenance and coin laundry store management. Washer-dryer technical support and troubleshooting. What parts to have on hand for emergencies. What's new in coin laundry and on premise laundry washers and dryers.



Tuesday, October 25th
MCC Warehouse
Menomonee Falls, WI
9:00am-3:15pm

Thursday October 27th
Hilton Garden Inn
Shoreview, MN
9:00am-3:15pm

Register online at
www.minnesotachemical.com or call Tina
at 800-328-5689 and she will sign you up!

Full Day Seminar With Lunch. Featured vendors:

- Huebsch
- Milnor – (Shoreview Show)
- Minnesota Chemical Co. – Service Techs and Sales Representatives
- Vend-Rite
- CCI/FasCard/LaundryCard/Card Concepts
- Standard Change-Makers – Tom Kozlik
- SpyderWash Card Systems

Calendar of Events

October 4 – Upper Mississippi Valley Association for Linen Management October Meeting, St Luke's Hospital, Duluth, MN www.umvailm.org

October 7 – Wisconsin Fabricare Annual Conference, www.wiscleaner.com

October 25 – Minnesota Chemical Co. Free Fall Show, MCC Warehouse Menomonee Falls, WI www.minnesotachemical.com

October 27 – Minnesota Chemical Co. Free Fall Show Hilton Garden Inn, Shoreview, MN www.minnesotachemical.com

November 16-17 – Coin Laundry Association WASH DRY FOLD SEMINAR, Hilton Chicago/Oakbrook Hills Resort <https://www.coinlaundry.org/events/calendar/>

Watch for news: <https://minnesotadrycleaners.org/>

Road trip Idea: Visit Sankosha, see and try out live finishing equipment. Call for appointment (888) 427-9120 www.sankosha-inc.com

3750 Dunlap Street North
 Arden Hills, MN 55112
 651-646-7521
 Toll Free: 1-800-328-5689
 Fax: 651-649-1101

13636 Carmen Avenue
 Suite 4
 Menomonee Falls, WI 53051
 262-781-8630

Equipment Department Manager: Mike Baker
Equipment Coordinator: Christine Evenson
Equipment Sales: Daniel Baker, James Baker, Tony Crain, James Riopel
Front Desk: Tina Hinrichs

Service Manager: Ed Jensen
Service Engineers: Dan Elstad, Phil Hall, Andy Putnam, Aaron Brown
Supply Sales: John Sullivan, Chris Schiefelbein, James Riopel
Parts Manager: Barbara Swanson

Warehouse: Bruce Edwards, Warehouse Manager, Ed McGarrity, Assistant
Purchasing/Accounts Payable/ Supply Department Manager: Chris Schiefelbein
CFO: Kwen Johnson
City Desk: Chris Schiefelbein

Parts Direct Line: 651-288-4849 • Service Direct Line: 651-288-4857 • Parts & Service Fax: 651-646-7206

NOW HIRING: FT MAINTENANCE TECH – Call Ed Jensen 651-288-4857



Supply Ideas by Chris Schiefelbein, John Sullivan and James Riopel

We have stock in Arden Hills and we can ship same day!!!! We stock thousands of items from ECOLAB, Pariser, AL Wilson, UNX, as well as thread, stain removers, hangers, poly bags, R&B Carts.....

Call Chris, John or James. If we don't have it, we will ship it from a factory FAST.



The Minnesota Chemical Co. People

We welcome Ed McGarrity as warehouse assistant. Ed has been working as a substitute teacher, mostly with special ed students, since 2016. Before that, he worked as a self-employed guitar instructor for about

15 years. He was a factory warehouse worker for 23 years. Ed is a man of many talents and interests, and we are glad to have him working with us part time in our warehouse.



CHICAGO®



CHICAGO DRYER COMPANY



Think of Chicago Dryer Air Chicago small piece folders for labor saving in your laundry. Chicago's air induced folding produces folded linen as much as 5 times as fast as hand folding – and items are counted, stacked and returned to the operator. Photo shows the Air Chicago Quattro which also sorts and stacks linen into four different sizes.



Equipment

New Milnor Washer/Extractors at MSRP

– 30015T6X, 40#, EP Express Micro, RinSave, 4 Speed, 208/240/60/3.....	\$17,995
– 30015VRJ, 40#, EP Plus Micro, Temp Control, RinSave 7 Speed, 208/240/60/3.....	\$19,445
– 30015V8Z, 40#, MilTouch Programmer, Temp Control, RinSave, 7 Speed, 208/240/60/3	\$21,525
– 30022T6X, 60#, EP Express Micro, RinSave, 4 Speed, 208/240/60/3.....	\$19,195
– 30022VRJ, 60#, EP Plus Micro, Temp Control, RinSave 7 Speed, 208/240/60/3	\$20,095
– 30022V8Z, 60#, MilTouch Programmer, Temp Control, RinSave, 7 Speed, 208/240/60/3	\$21,795
– 36021V5J, 80#, EP Plus, Temp Control, RinSave, 7 Speed, 208/240/60/3	\$28,495
– 36021V7Z, 80#, MilTouch Programmer, Temp Control, RinSave, 7 Speed, 208/240/60/3	\$33,875
– 36026V5J, 100#, EP Plus, Temp Control, RinSave, 7 Speed, 208/240/60/3	\$31,895
– 36026V7Z, 100#, MilTouch Programmer, Temp Control, RinSave, 7 Speed, 208/240/60/3	\$37,495

– 42026V6Z, 140#, MilTouch Programmer, Temp Control, RinSave, 7 Speed, 208/240/60/3	\$42,135
– 42030V6Z, 160#, MilTouch Programmer, Temp Control, RinSave, 7 Speed, 208/240/60/3	\$45,945

RinSave saves water and formula time by special speeds and saving 1 or 2 rinses. MilTouch is touchscreen programmer with laptop programmability – transfer formulas by USB stick.

New Dryers at MSRP

– Huebsch HT055FN, Gas, 50#, Dual Digital Timers, Slimline, reversing, passes through 34.5" doorway, various voltages	\$6,697
<i>120#, 170#, and 200# dryers are available in reversing and with Galaxy Micro Control and OPT True Moisture Sensing Drying</i>	
– Huebsch HT075FN, Gas, 75#, Dual Digital Timers, non reverse, various voltages	\$7,010
– Huebsch HT075FN, Gas, 75#, Dual Digital Timers, reversing, various voltages	\$8,388
– Huebsch HT075NN, Gas, 75#, Galaxy Micro Control, reversing, OPT True Moisture Sensing Drying various voltages	\$9,502

All Huebsch dryers (except electric heat) have available in the basket CARE fire suppression including remote connect for cold enclosures.

Other Huebsch dryers in sizes from 25# to 200#. And ask about stainless steel cylinder and panels. Ask about **ADC** and **CLM** dryers in large capacities.

MSRP is a good BUDGET estimate of final washer or dryer price after discount allowed, freight and delivery added back in. Your price could be less!

**SPECIALS IN STOCK: Used Chicago Comet 80" ironer \$7,500 FOB MCC.
New R&B Wire RBSP-1000 Laundry Floor Scale, List \$2,607, special \$2,500 FOB MCC.**



Service Tips By Ed



Soft Mount Washers

Soft mount washers have a lot of moving parts, so it is important to load these machines properly to assure long life. It is harder on these machines to underload than it is to overload. The best way to judge if a machine is properly loaded is when load is fully saturated and basket has stopped

to reverse - look for an opening between 11:00 and 1:00. A grossly overloaded washer will not wash properly and could cause damage as well. Sort loads properly - one should never wash terry towels with sheets. Proper loading helps assure that goods do not ball up and cause the washer to go out of balance.

Do normal PMs monthly. Many washers 80lbs or bigger must be greased once a month. Inspect belts for wear, check for leaks from water valves, drain valves, door gaskets and under the machine. Inspect the shocks and springs for wear. Shocks that leak oil must be replaced – in a full set. If you are hearing noises coming from the washer, get it checked out before it goes down and you are without a washer.

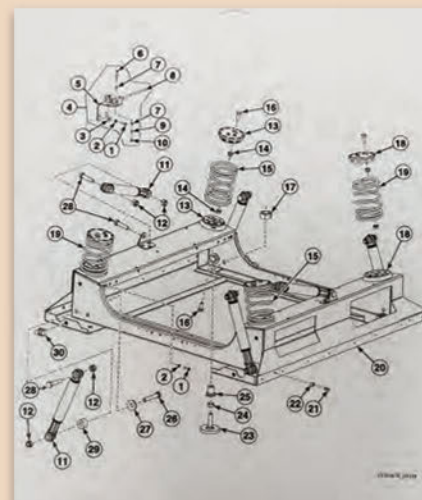



Parts Ideas From Barb

IGNITOR-FLAME SENSORS AND THERMOSTATS

Before dryers begin to have trouble, check spark ignitors and thermostats. Clean off any lint and debris.

Flame sensors need to be monitored for safety reasons.

Huebsch/Speed Queen/Unimac and Milnor/ADC thermostats, temperature probes, high limit thermostats are generally in stock.

We also have Chicago Dryer ignitors and flame circuit parts.

Glow-bar ignitors and hot surface ignitors are also available.

Call me, I will help you determine the parts needed. DIRECT 651-288-4849



Huebsch laundromat equipment is the best! Made in Ripon, WI, Huebsch has the features you need for your hotel guest laundry, laundromat new store or to upgrade your laundromat. Huebsch Command™ gives you total control of your laundromat from anywhere! New softmount washers from 20# to 70# mean almost any building works for a new laundromat. Call Dan Baker, James Riopel, Tony Crain or James Baker for your Huebsch needs.



Milnor's USA factory is in Kenner, LA, near New Orleans airport. As you can see, Milnor is not too far from the Mississippi River but protected by a levee. The factory made it though the recent hurricane OK. Power has been restored to the factory and homes of the staff. Milnor is back in full production.

